



Enjoy the Dolce Vita.

It is a feeling that travels with you. A strong aesthetic sensation in form and colour. Great enjoyment from the materials and their craftsmanship. You enjoy the finer things in life. Travelling around the world and yet all your senses are at home in Italy.

Enjoy
the Dolce
Vita.

Table of contents

Kosmo	20	Highlights
	26	Interior
	40	Materials
	42	Kosmo Emblema
	48	Overview
52	Layouts	
Ecovip	58	Highlights
	64	Interior
	78	Materials
	82	Overview
	84	Layouts
Kreos	90	Highlights
	96	Interior
	110	Materials
	114	Overview
	117	Layouts

KOSMO

OUR ENTRY-LEVEL SERIES



p. 18

ECOVIP

OUR NEW CLASSICS



p. 56

KREOS

OUR PREMIUM MODELS



p. 88

Stories in the catalogue



Made in San Casciano p. 118

Tradition meets modern design.



La Dolce Vita p. 122

Discover Italy with Laika.



The Laika story p. 128

How the dog learned to fly.

You can find more information on Laika at www.laika.it





Made in Italy.
Perfect everywhere.







Beauty moves you.
Wherever you want.



Italian craftsmanship
enchants the eyes.
And inspires the mind.





The beginning of a great love story. With nature. With the outdoor lifestyle. With freedom. Regardless of whether you are travelling alone, with a loved one, or with the whole family: The Kosmo series is your uncomplicated entry into a world full of beauty, comfort and flexibility.

OUR ENTRY-LEVEL SERIES

KOSMO

Come in, look around and feel at home. Four walls are waiting for you, which were manufactured with great care and precision. For everything you have in mind.

WHAT MAKES KOSMO UNIQUE



Welcome home.

Your Kosmo welcomes you with a spacious entrance. The central locking is carried out via a remote control. A mosquito net provides a peaceful night with a pleasantly cool breeze.



Lots of space and lots
of possibilities.

The garage with 150 kg payload, low load floor and non-slip surface offers space for everything that is essential when travelling.



Innovative technology
meets Italian design.

The indirect, multi-stage LED lighting in the cab and living room creates cosy evenings.



Light, exactly where
you need it.

The reading lamp with integrated USB connection for spending hours with a really good book.



Generous
in every way.

The standing height of up to 213 cm creates a pleasant living atmosphere and plenty of space to make new plans.





Wherever the road leads, the journey will be extremely comfortable. This is because the Kosmo interior is ergonomically shaped and offers comfortable pillows and cushions. Practical construction and Italian design are combined with ease.

The table in the centre can be extended up to a length of 1.40m. Fold-down panels can be used to create two additional seats with cushions, making a total of six (Kosmo over-cabs).

LIVING SPACE

A room open to everyone.



509



509



When summer turns into autumn, a heating system, special anti-condensation walls and a ventilation system in the furniture provide heat in the room.

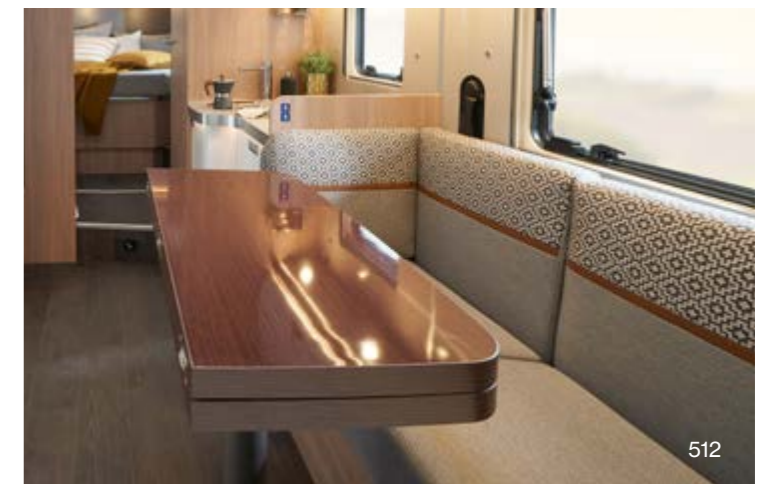



When designing the interior of the Kosmo, we do everything we can to make the surfaces user-friendly and visually appealing. This is why the kitchen has a scratch-resistant and fingerprint-resistant work surface and is also equipped with practical shelves. From bruschetta to a three-course meal, everything is possible.

KITCHEN

The open space concept invites you to cook, linger and enjoy.



Nothing is missing in the Kosmo's kitchen. Thanks to the wall units with large doors, it offers plenty of storage space and is well thought through, right down to the smallest detail.





Wonderful
comfort.

Fall asleep relaxed and wake up full of energy. The Kosmo mattresses are wonderfully comfortable and boast machine-washable covers. Two side windows and a roof window give the room an open ambience. The effective lighting provides warmth and cosiness.

SLEEPING AREA





Refreshing
relaxation.

The bathroom, which is tailored to individual needs, offers enough storage space for everything you could possibly need on a journey. The separate shower ensures comfort without compromise. A great way to start the day refreshed.

BATHROOM



509

The bathroom door also serves as a partition to the living space.



512

QUALITY STARTS WITH THE BEST MATERIALS.

Living world Noto and furniture décor Pero Toscano



MATERIALS & COMBINATIONS

The Kosmo models are available in various shapes and sizes. Conceived, designed and manufactured with attention to detail and excellent Tuscan craftsmanship, each model is unique. Discover the right one for you in our diverse range.

LIVING WORLD



Noto

FURNITURE DÉCOR



Pero Toscano

OPTIONAL LIVING WORLDS



Alba



Udine leatherette

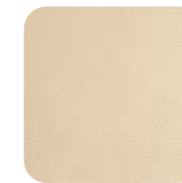

Firenze leatherette



VIP Club real leather

The semi-integrated Kosmo Emblema travels with you to every destination and is the ideal home on wheels. Its high-quality design and the technically valuable equipment invite you to linger,... and travel the world.



KOSMO EMBLEMA LOW-PROFILES

COMFORT

- Pleated driver's cab blinds
- Electric drop-down bed available as an option
- Rear beds with wooden slats, high quality, breathable mattresses with machine washable stretch lining
- Toilet with window, blinds and mosquito net

DESIGN

- 16" alloy wheels
- Continuous front windshield in fibreglass with integrated maxi roof-light
- Automotive headlights and split rear for easy replacement if needed
- High quality, flat frame windows with aluminium frame, blind and mosquito net
- Living room with comfortable upholstery, adjustable headrests and cushions with removable lining
- Multi-level indirect lighting in driver's cab and living area
- Rear bed headboard with indirect LED lighting

TECHNIQUE

- Engine Fiat 2,3 l, 140 HP
- Multimedia system with 2Din-radio, speakers in driver's cabin and living room, satellite navigation system and rear view camera
- Walls and roof highly insulated with EPS foam, roof lined in hail protection fibreglass, aluminium external walls, anti-yellowing
- Fibreglass sub-floor for maximum resistance to gravel and weathering over time
- Trivalent 140 l refrigerator with automatic energy source selection (AES)
- Extractor hood in kitchen (not possible on Emblema 509 LE and 512 E in combination with drop-down bed)
- 6kW heating system and boiler with heat distribution and ducting throughout the interior, including rear garage and driver's cabin, programmable digital control panel
- Electrical system with automatic battery charger 18 A, maintenance-free high-performance service battery 95 A, on-board control panel with LED display
- 100% LED lighting
- Drinking water tank 110 l, easily accessible for cleaning and inspection, high-capacity electric immersion water pump

- Exhaust pipes with anti-odour siphons, recovery tank complete with external vent
- Insulated and heated waste water tank
- Convector and floor heating available as an option

CHOOSE YOUR IDEAL COMBINATION.

All Kosmo Emblema models can be combined with materials and designs from the classic Kosmo series.

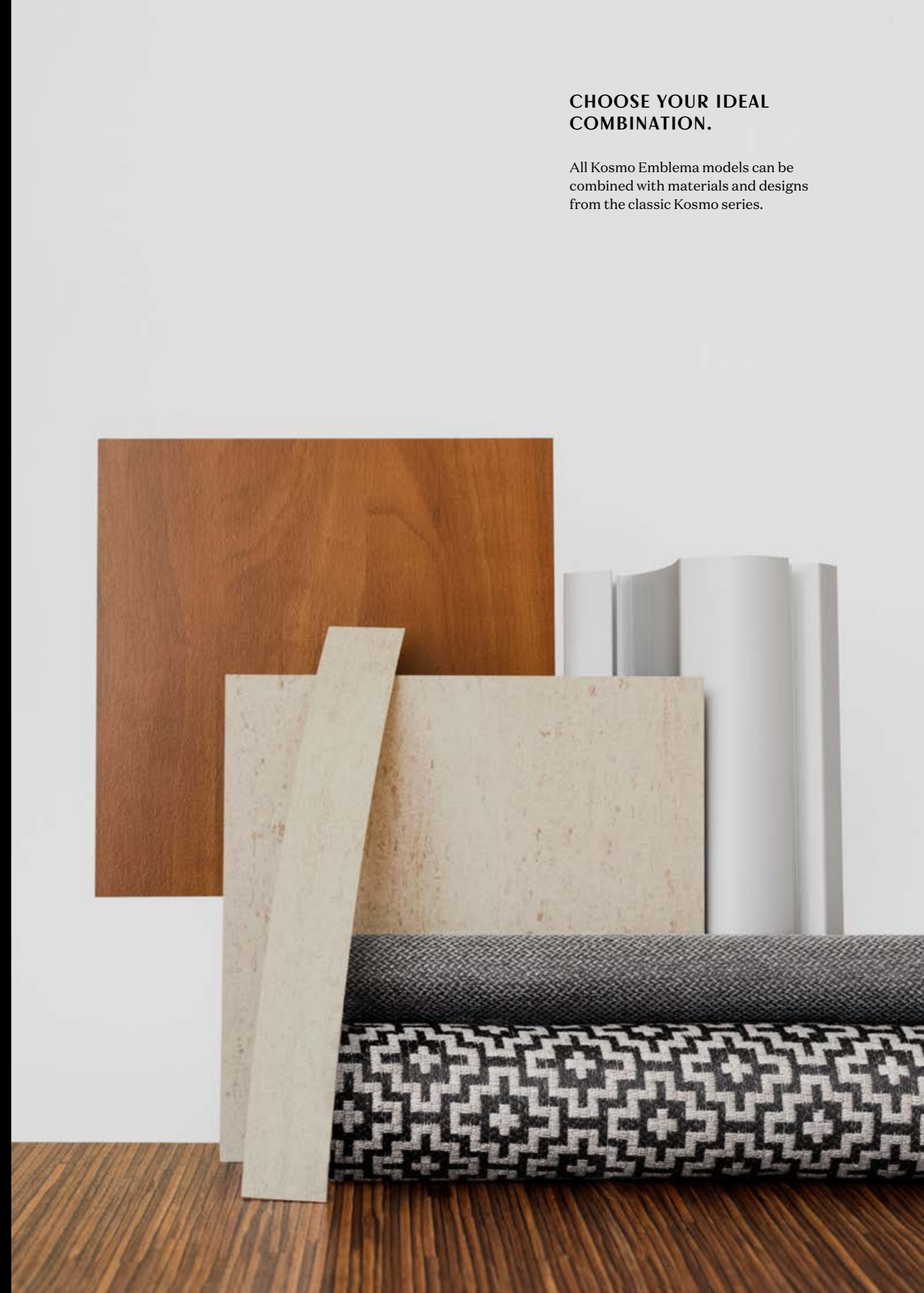



909 E



909 E

Voluminous and studied to perfection down to the last detail. The integrated Kosmo Emblema offers plenty of space when travelling. Alone, as a couple or with the whole family - thanks to the flexible volume distribution it offers enough space for everyone.



KOSMO EMBLEMA MOTORHOMES

COMFORT

- Pleated driver's cab blinds
- Rear beds with wooden slats, high quality, breathable mattresses with machine washable stretch lining
- Integrated drop-down bed with slats and high comfort mattress, courtesy awning, roof-light with transparent dome, double reading lights, shelf and separation curtain for maximum privacy
- Toilet with window, blind and mosquito net

DESIGN

- 16" alloy wheels
- Continuous front windshield in fibreglass with integrated maxi roof-light
- Automotive exterior graphics with mirrored chrome elements, Emblema customised elements on each side of the vehicle for an elegant and dynamic appearance
- Automotive headlights and split rear for easy replacement if needed
- High quality, flat frame windows with aluminium frame, blind and mosquito net
- Living room with comfortable upholstery, adjustable headrests and cushions with removable lining

- Multi-level indirect lighting in driving cab and lounge
- Rear bed headboard with indirect LED lighting

TECHNIQUE

- Fiat 2,3 I, 140 HP Engine
- Multimedia system with 2Din-radio, speakers in driver's cabin and living room, satellite navigation system and rear view camera
- Walls and roof highly insulated with EPS foam, roof lined in hail protection fibreglass, aluminium external walls, anti-yellowing
- Fibreglass sub-floor for maximum resistance to gravel and weathering over time
- Trivalent 140 l refrigerator with automatic energy source selection (AES)
- Extractor hood in kitchen
- 6kW heating system and boiler with heat distribution and ducting throughout the interior, including rear garage and driver's cabin, programmable digital control panel
- Electrical system with automatic battery charger 18 A, maintenance-free high-performance service battery 95 A, on-board control panel with LED display
- 100% LED lighting

- Drinking water tank 110 l, easily accessible for cleaning and inspection, high-capacity electric immersion water pump
- Exhaust pipes with anti-odour siphons, recovery tank complete with external vent
- Insulated and heated waste water tank
- Convector and floor heating available as an option



Elegance inspired by Italy, intelligently executed. The Kosmo low-profiles offer incomparable comfort. A classic motorhome that leaves nothing to be desired. With an optional fold-down bed.



KOSMO LOW-PROFILES

COMFORT

- Scratch and fingerprint resistant kitchen and table tops
- Rear beds with wooden slats, high quality, breathable mattresses with machine washable stretch lining
- Padded rear headboard
- Electric drop-down bed available as an option
- Bathroom door can also be used as separation from the lounge area (Kosmo 509, 509L, 512)

DESIGN

- Undergoing roof hatch in GFK, with integrated maxi roof-light
- Automotive headlights and rear bumper for easy replacement if needed
- Aluminium underbody skirts
- High quality, flat frame windows with aluminium frame, blinds and mosquito net
- White glossy wall units, metal handles and high-quality mechanical and closing components
- Living room with comfortable upholstery, adjustable headrests and cushions with removable lining

- Multi-level indirect lighting in driving cab and lounge
- Window design cladding in kitchen and lounge area

TECHNIQUE

- Walls and roof highly insulated with EPS foam, roof lined in hail protection fibreglass, aluminium external walls, anti-yellowing
- Fibreglass sub-floor for maximum resistance to gravel and weathering over time
- 6kW heating system and boiler with heat distribution and ducting throughout the interior, including rear garage and driver's cabin, programmable digital control panel (only with Smart Home Pack)
- Trivalent 140 l refrigerator with automatic energy source selection (AES)
- Electrical system with automatic battery charger 18 A, maintenance-free high-performance service battery 95 A, on-board control panel with LED display (only with Smart Home Pack)
- 100% LED lighting
- Drinking water tank 110 l, easily accessible for cleaning and inspection, high-capacity electric immersion water pump

- Exhaust pipes with anti-odour siphons, recovery tank complete with external vent
- Toilet with swivel bowl and removable cassette 18 litres (frost-resistant)
- Gas compartment for two 10 kg cylinders, steel gas pipes, safety isolating valves

Versatile, agile and spacious at the same time. The intelligent spatial concept of the Kosmo Compact makes it an ideal companion for all journeys. And these may sometimes lead through the narrow streets of Italian cities. With optional fold-down bed.



KOSMO COMPACT

COMFORT

- Scratch and fingerprint resistant kitchen and table tops
- Rear beds with wooden slats, high quality, breathable mattresses with machine washable stretch lining
- Padded back headboard
- 70 x 50 cm roof-light in the living area (only with Comfort Pack)
- Extendable table
- The separate shower is easily accessible thanks to the rotation of the washbasin wall

DESIGN

- Aerodynamic windscreen and ABS fittings between the driving area and the living area
- Automotive headlights, rear bumper easy to replace if needed
- ABS side skirts
- High quality, flat frame windows with aluminium frame, blinds and mosquito net
- White glossy wall units, metal handles and high-quality mechanical and closing components
- Living room with comfortable upholstery, adjustable headrests and cushions with removable lining

- Indirect, multi-level lighting in the driver's cab and living area
- Adjustable reading lights in the driver's cab with USB sockets for power supply and to charge mobile devices

TECHNIQUE

- Walls and roof highly insulated with EPS foam, roof lined in hail protection fibreglass, aluminium external walls, anti-yellowing
- Electric entrance step
- 4kW heating system and boiler with heat distribution and ducting throughout the interior, including rear garage and driver's cabin
- Trivalent 89 l refrigerator (incl. 11 l freezer) with automatic energy source selection
- Electrical system with automatic battery charger 18 A, maintenance-free high-performance service battery 95 A, on-board control panel with LED display
- 100% LED lighting
- Drinking water tank 110 l easily accessible for cleaning and inspection, high-capacity electric immersion water pump
- Exhaust pipes with anti-odour siphons, recovery tank complete with external vent

- Toilet with swivel bowl and 18 l removable cassette (frost-resistant)
- Gas compartment for two 10 kg cylinders, steel gas pipes, safety isolating valves

Inviting elegance and spacious structure. Kosmo's over-cabs offer an integrated sleeping area and therefore enough space for the whole family and a vacation with a lot of living comfort.



KOSMO OVER-CABS

COMFORT

- Scratch and fingerprint resistant kitchen and table tops
- Rear beds with wooden slats, high quality, breathable mattresses with machine washable stretch lining
- Padded rear bed headboard
- Comfortable internal height of 209 cm
- Dropdown bed in the coachbuilt
- Large toilet with wooden furniture, large sink, window and skylight, separate shower with thermoformed interior, separation by methacrylate doors, fitted column, and retractable coat rack

DESIGN

- Spacious coachbuilt with external ABS cover, two windows and skylight
- Automotive headlights, rear bumper easy to replace if needed
- Aluminium side skirts
- High quality, flat frame windows with aluminium frame, blinds and mosquito net
- White glossy wall units, metal handles and high-quality mechanical and closing components
- Living room with comfortable upholstery, adjustable headrests and cushions with removable lining

- Multi-level indirect lighting in driving cab and lounge
- Window cladding design in kitchen and lounge

TECHNIQUE

- Walls and roof highly insulated with EPS foam, roof lined in hail protection fibreglass, aluminium external walls, anti-yellowing
- Fibreglass sub-floor for maximum resistance to gravel and weathering over time
- 6kW heating system and boiler with heat distribution and ducting throughout the interior, including roof, rear garage and driver's cabin, programmable digital control panel (only with Smart Home Pack)
- Trivalent 113 l refrigerator with automatic energy source selection (AES)
- Electrical system with automatic battery charger 18 A, maintenance-free high-performance service battery 95 A, on-board control panel with LED display
- 100% LED lighting
- Drinking water tank 110 l, easily accessible for cleaning and inspection, high-capacity electric immersion water pump

- Exhaust pipes with anti-odour siphons, recovery tank complete with external vent
- Toilet with swivel bowl and removable cassette 18 l (frost-resistant)
- Gas compartment for two 10 kg cylinders, steel gas pipes, safety isolating valves

The open and spacious concept of Kosmo Motorhomes make them a real home-from-home when travelling. Adapted length and extended room height for endless possibilities. With optional fold-down bed.



KOSMO MOTORHOMES

COMFORT

- Scratch and fingerprint resistant kitchen and table tops
- Rear beds with wooden slats, high quality, breathable mattresses with machine washable stretch lining
- Padded rear headboard
- Integrated drop-down bed with slats and high comfort mattress, courtesy awning, roof-light with transparent dome, double reading lights, shelf and separation curtain for maximum privacy
- Sliding door rear bedroom / living area (Kosmo 909L, 912)

DESIGN

- One-piece front windshield in fibreglass with integrated maxi roof-light
- Automotive headlights and split rear for easy replacement if needed
- Aluminium underbody skirts
- High quality, flat frame windows with aluminium frame, blind and mosquito net
- White glossy wall units, metal handles and high-quality mechanical and closing components
- Living room with comfortable upholstery, adjustable headrests and cushions with removable lining

- Multi-level indirect lighting in driving cab and lounge
- Window design cladding in kitchen and lounge area

TECHNIQUE

- Walls and roof highly insulated with EPS foam, roof lined in hail protection fibreglass, aluminium external walls, anti-yellowing
- Fibreglass sub-floor for maximum resistance to gravel and weathering over time
- 6kW heating system and boiler with heat distribution and ducting throughout the interior, including rear garage and driver's cabin, programmable digital control panel
- Trivalent 140 l refrigerator with automatic energy source selection (AES)
- Electrical system with automatic battery charger 18 A, maintenance-free high-performance service battery 95 A, on-board control panel with LED display (only with Smart Home Pack)
- 100% LED lighting
- Drinking water tank 110 l, easily accessible for cleaning and inspection, high-capacity electric immersion water pump

- Exhaust pipes with anti-odour siphons, recovery tank complete with external vent
- Toilet with swivel bowl and removable cassette 18 l (frost-resistant)
- Gas compartment for two 10 kg cylinders, steel gas pipes, safety isolating valves

KOSMO LAYOUTS

KOSMO COMPACT 5 COMPACT

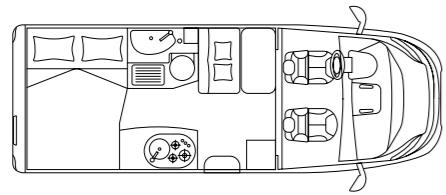

↔ 595 cm 2 (+1)

KOSMO COMPACT 9 COMPACT

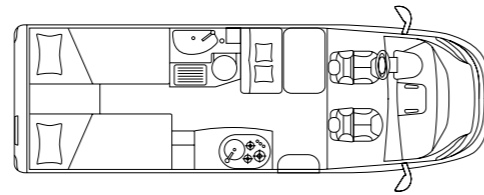

↔ 665 cm 2 (+1)

KOSMO 209 LOW-PROFILE

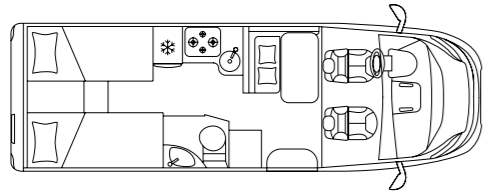

↔ 695 cm 2 (+2)

KOSMO 509 LOW-PROFILE

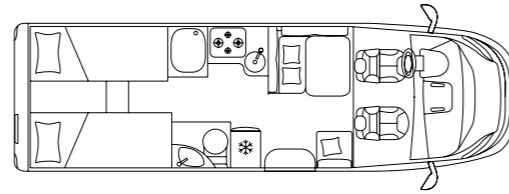

↔ 741 cm 2 (+ 2 + 1)

KOSMO 509L LOW-PROFILE

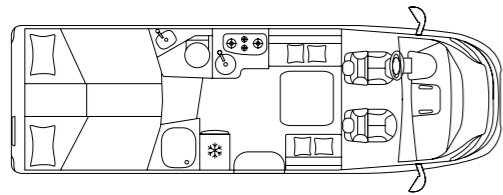

↔ 741 cm 2 (+2 + 1)

KOSMO 512 LOW-PROFILE

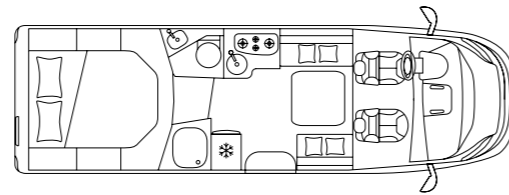

↔ 741 cm 2 (+2 + 1)

KOSMO F510 OVER-CAB

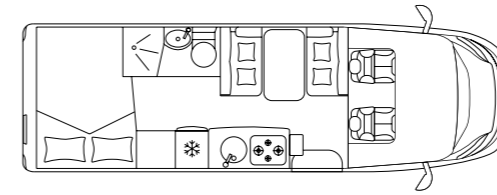

↔ 725 cm 4 (+1)

KOSMO 909 MOTORHOME

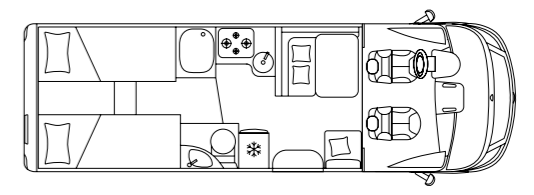

↔ 741 cm 4 (+1)

KOSMO 909L MOTORHOME

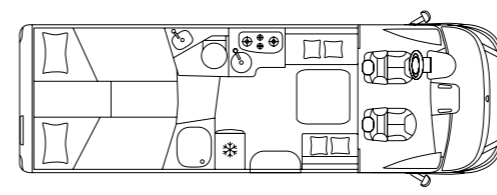

↔ 741 cm 4 (+1)

KOSMO 912 MOTORHOME

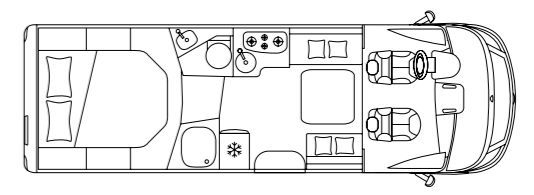

↔ 741 cm 4 (+1)

KOSMO EMBLEMA 209E LOW-PROFILE

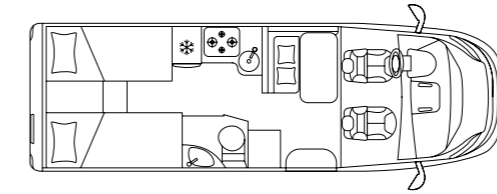

↔ 695 cm 2 (+2)

KOSMO EMBLEMA 509E LOW-PROFILE

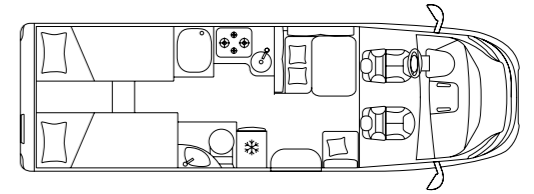

↔ 741 cm 2 (+ 2 + 1)

KOSMO EMBLEMA 509LE LOW-PROFILE

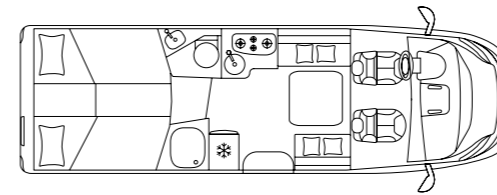

↔ 741 cm 2 (+ 2 + 1)

KOSMO EMBLEMA 512E LOW-PROFILE

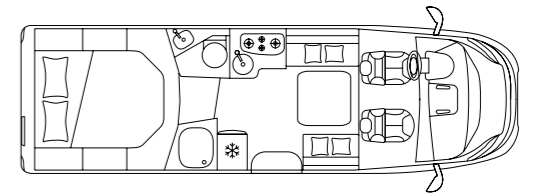

↔ 741 cm 2 (+ 2 + 1)

KOSMO EMBLEMA 909E

MOTORHOME

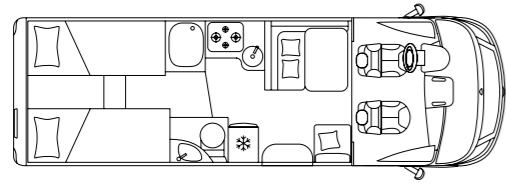

↔ 741 cm  4 (+1)

KOSMO EMBLEMA 909LE

MOTORHOME

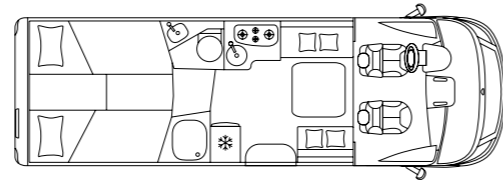

↔ 741 cm  4 (+1)

KOSMO EMBLEMA 912E

MOTORHOME

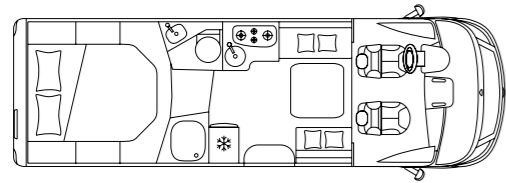

↔ 741 cm  4 (+1)



Scan the QR code and discover more about your favourite model!





Italian craftsmanship can be visually enchanting. And technically impress. The Ecovip series has been an integral part of the Laika range since 1992 and will impress you and your family for decades. With excellent technology and an unforgettable mix of beauty, comfort and adventure.

OUR NEW CLASSICS

ECOVIP

Surprises are followed by great enthusiasm. The new Ecovip opens the door to the world and arouses curiosity. For long or spontaneous trips, in pairs or all together. The possibilities are as endless as the Tuscan hills.

WHAT MAKES ECOVIP UNIQUE



Elegance and
intelligence.

The high-quality interior is inspired by the elegance of Italian furniture. It is equipped with perfect flowing shapes and curved surfaces and offers sophisticated details. The wardrobes can be pulled out on both sides, for example.



The journey begins here.

The extra wide premium body door is particularly inviting with a comfortable entrance. There is also an electrical step and central locking with remote control. With a mosquito net and blackout curtains, deep, refreshing sleep is planned in.



L3009

Endless possibilities.

The heated and illuminated double floor stores heat and also acts as an ideal storage space. Accessible from outside and inside.



L3009

A stepless floor.

The pleasant, ground-level living room extends to the rear bedroom without steps and provides a luxurious feeling of living.



L3009

Everything where you need it.

The low loading edge of the garage enables easy loading and unloading of up to 250 kg. This way you can take everything you need to make your trip unforgettable.



L3009



A living space modelled on an elegant living room. With a room height of 205 cm, the Ecovip offers plenty of room for dreams. A lot of emphasis was placed on elegance in the design. The well-upholstered seats will make the living area your new favourite place, regardless of whether the journey leads to rough coastlines or gentle hilly landscapes.

LIVING ROOM

Room
to relax.

ECOVIP



L3009



L3009

The beauty of the Ecovip's interior design impresses at first glance. However, the special features lie in the details.



L3009



L3009

Good food is an important part of every trip. The Ecovip kitchen offers the very best conditions for this with a spacious hotplate, chrome-plated steel fittings

and large sink. It has enough storage space for fresh vegetables or your favourite tableware. Your passion for cooking can be rekindled here and really lived.

KITCHEN

Designed with love.
Cooked with love.



L3019

The design enables a smooth transition from the living area to the kitchen.



L3019



L3009



The indirect lighting illuminates the entire room and creates a warm atmosphere. Warm summer nights find the perfect end here.



L3019

Every night is a dream in the Ecovip sleeping area. This is because the natural latex mattress with slatted frame ensures ideal lying comfort. Sufficient storage

space creates order and an indirect lighting concept creates a relaxed atmosphere. All in all, the area is an ideal retreat for reading, a film night or just relaxing.

SLEEPING AREA

Luxury with a broad perspective.



The large windows bring the vastness of the landscape directly into the sleeping area.

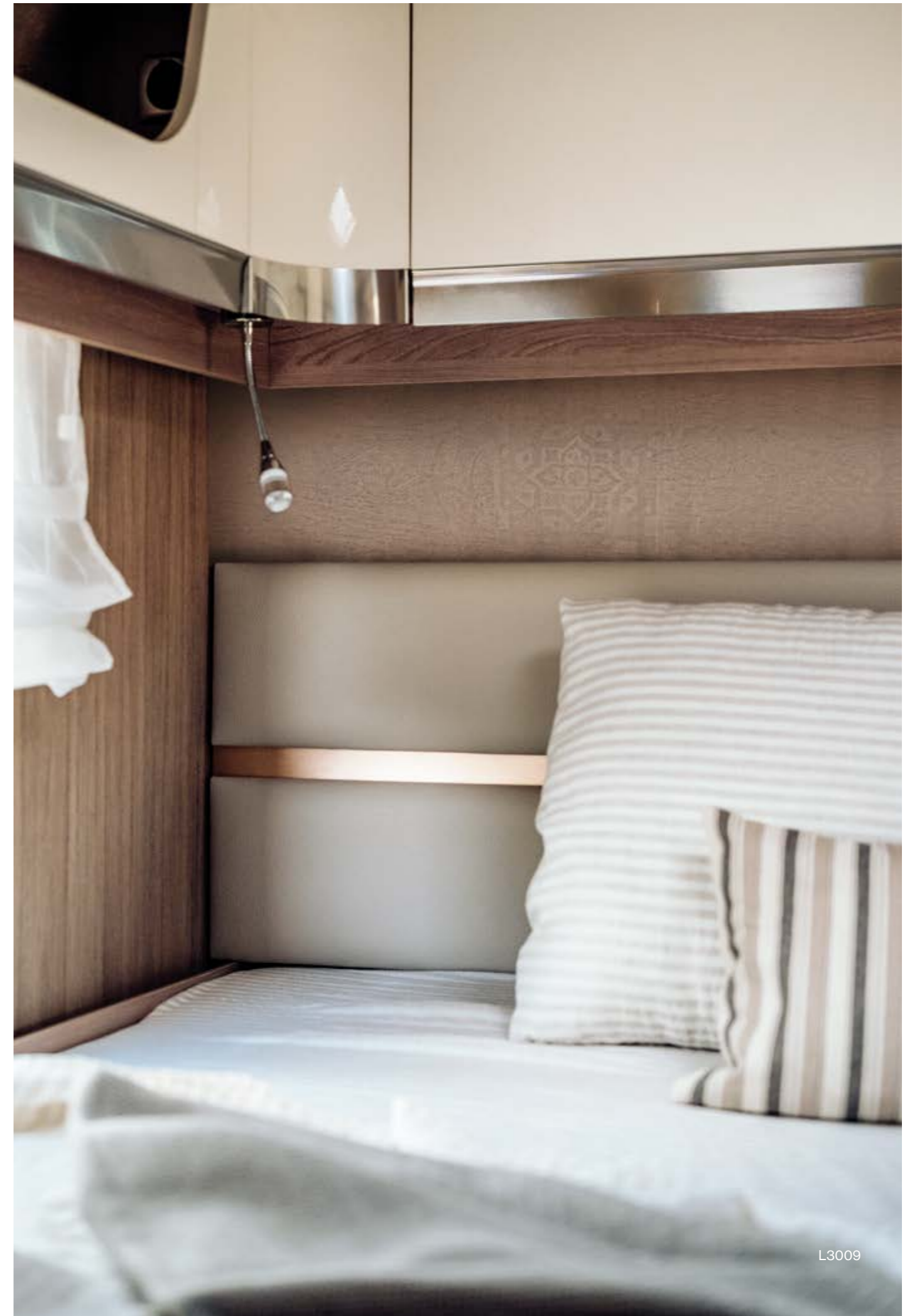

L3009



Fresh throughout
the day.



The Ecovip combines elegance and well-being so effortlessly that they become one. The shower, the large sink and numerous cupboards and storage areas exceed all expectations of comfort.

The sophisticated Italian design is combined with practical details, so that all the important things are always exactly where you need them.

BATHROOM



**QUALITY KNOWS NO
COMPROMISE.**

Living world Bari and furniture
décor Rovere Moka



MATERIALS & COMBINATIONS

The Ecovip models are characterised by many different shapes and sizes. You can choose what suits you best. A mix of warm wood design, refined with copper accents, creates a sensual overall concept.

Throw pillow
Back padding
Living world
Furniture décor

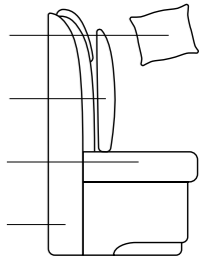

LIVING WORLD



Bari series



Udine leatherette



VIP Club real leather

FURNITURE DÉCOR



Rovere Moka series



Pero Toscano

BACK CUSHION & DECORATIVE PILLOW



Toscana & Arno series



Liguria & Adda

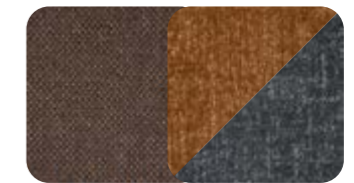

Veneto & Piave



Lazio & Adda



VIP Club



Umbria & Elsa



Sardegna & Pesa



Sicilia & Reno



The Ecovip low-profile combines all the properties that define Laika. Exquisite Italian design with technical highlights. Thanks to an inner standing height of 205 cm, it provides enough space for your dream trip.



ECOVIP LOW-PROFILES

COMFORT

- TV compartment for LCD/LED screens up to 32"
- Electrical drop-down bed (optional) with reading lights and USB sockets, high quality mattress, slatted frame and safety anti-fall net
- Seats with variable storage space underneath in the double floor, great for large items that need to be transported

DESIGN

- One-piece fibreglass front and highly insulated and heated connection between living and driver's cab area
- Rear wall with automotive design, LED lights and dynamic indicators
- Insulated/upholstered ceiling with elegant Laika-Iso-Deluxe material

TECHNIQUE

- Walls and roof structure in polyurethane, highly insulation of walls, roof and floor thanks to XPS foam, hail-resistant fibreglass roof, anti-yellowing aluminium walls
- Double technical flooring with heated and illuminated crawl space with external and internal access and heat storage function
- 140 or 160 l maxi refrigerator (depending on model, except Ecovip L2009/H2109) with separate freezer compartment and automatic selection of energy source
- Exterior doors with concealed hinges, new 'car-type' locks
- High-quality, multi-level, fully LED lighting system with multi-way and dimmer controls, with direct and indirect light sources covering every area of the living area, including entrance step, wardrobe cabinet, wall units, rear garage and double floor
- 6kW ducted hot air heating system with integrated boiler and programmable, performance-optimised, digital control panel (only with Smart Home Pack) with perimeter distribution in all areas of the vehicle including driver's cab, double floor, tanks and rear garage

- Convector heating and running heat exchanger available as an option
- Latest generation electrical system with CI-BUS technology, housing for two service batteries integrated in the double floor easily accessible, digital control panel with programmable and multifunctional colour LCD screen
- Fully antifreeze water system: fresh water and waste water tanks placed in the double floor and further protected by an insulated and heated polyurethane shell, easily accessible and removable (if needed)
- Pressure water pump with expansion tank in protected and heated room accessible from the rear garage
- Electric waste water drain operable from the rear garage

The special thing about Ecovip motorhomes, in addition to an unprecedented exterior and interior design, is the perfect insulation. It guarantees ideal temperatures and perfect comfort from early summer to late autumn.



ECOVIP MOTORHOMES

COMFORT

- TV compartment for LCD/LED screens up to 32"
- Drop-down bed completely integrated in the wall unit line, with slatted frame, high quality mattress, courtesy awning, adjustable reading lights, USB sockets for charging mobile devices, sky lights, dedicated storage compartment, heating, internal separation curtain for privacy and multi-way lighting system to control lights from the bed
- Seats with variable storage space underneath in the double floor, great for large items that need to be transported

DESIGN

- One-piece automotive-design fibreglass front panel, panoramic windshield, large engine hood for convenient and secure access to mechanical parts, extended fuel tank neck outside, exclusive grille
- Rear wall with automotive design, LED lights and dynamic indicators
- The driver's cab is perfectly heated thanks to the heating system being coupled to the central system
- LED daytime running lights

TECHNIQUE

- Walls and roof structure in polyurethane, highly insulation of walls, roof and floor thanks to XPS foam, hail-resistant fibreglass roof, anti-yellowing aluminium walls
- Heated and illuminated double floor, which retains heat, accessible from inside and outside for equipment and storage spaces
- 140 or 160 l maxi refrigerator (depending on model, except Ecovip L2009/H2109) complete with separate freezer compartment and automatic selection of energy source
- Exterior doors with concealed hinges, new 'car-type' locks
- High-quality, multi-level, fully LED lighting system with multi-way and dimmer controls, with direct and indirect light sources covering every area of the passenger compartment, including entrance step, wardrobe cabinet, wall units, rear garage and double floor
- 6kW ducted hot air heating system with integrated boiler and programmable, performance-optimised, digital control panel (only with Smart Home Pack) with perimeter distribution in all areas of the vehicle including driver's cab, double floor, tanks and rear garage

- Convector heating and running heat exchanger available as an option
- Latest generation electrical system with CI-BUS technology, housing for two service batteries integrated in the double floor easily accessible, digital control panel with programmable and multifunctional colour LCD screen
- Full antifreeze water system: fresh water and waste water tanks placed in the double floor and further protected by an insulated and heated polyurethane shell, easily accessible and removable (if needed)
- Pressure water pump with expansion tank in protected and heated room accessible from the rear garage
- Electric waste water drain operable from the rear garage

ECOVIP LAYOUTS

ECOVIP L2009 LOW-PROFILE

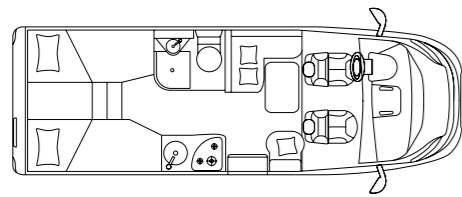

↔ 659 cm 2 (+1+1)

ECOVIP L3009 LOW-PROFILE

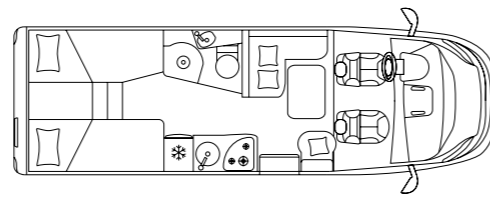

↔ 699 cm 2 (+1+1)

ECOVIP L3010 LOW-PROFILE

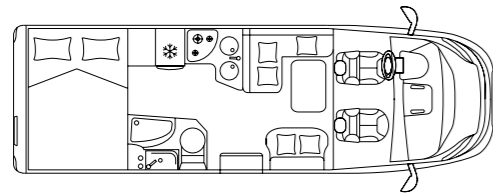

↔ 699 cm 2 (+2+1)

ECOVIP L3019 LOW-PROFILE

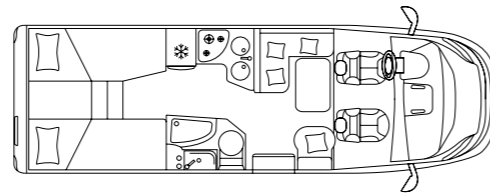

↔ 699 cm 2 (+2+1)

ECOVIP L3412DS LOW-PROFILE

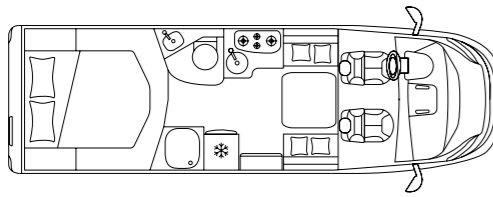

↔ 720 cm 2 (+2+1)

ECOVIP L4009 LOW-PROFILE

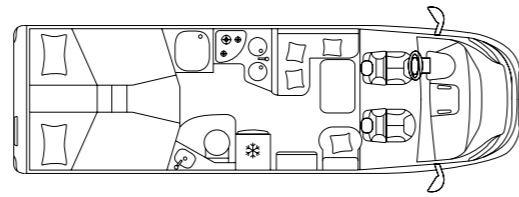

↔ 740 cm 2 (+2+1)

ECOVIP L4009DS LOW-PROFILE

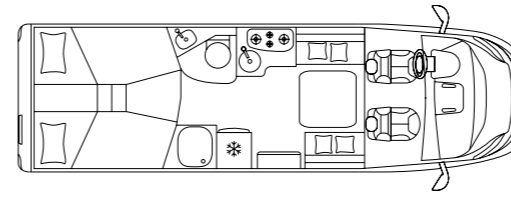

↔ 740 cm 2 (+2+1)

ECOVIP L4012 LOW-PROFILE

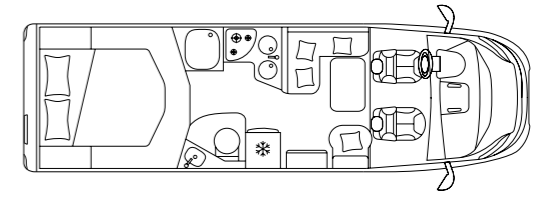

↔ 740 cm 2 (+2+1)

ECOVIP L4012DS LOW-PROFILE

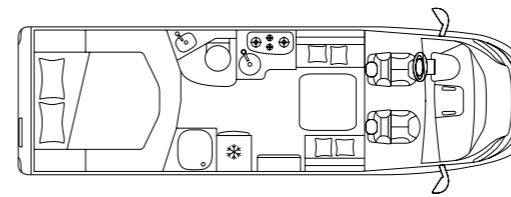

↔ 740 cm 2 (+2+1)

ECOVIP H2109 MOTORHOME

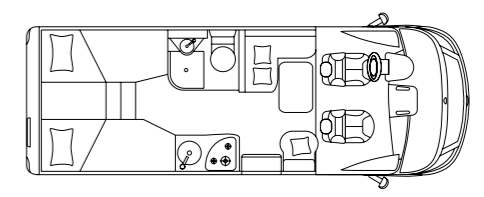

↔ 659 cm 4 (+1)

ECOVIP H3109 MOTORHOME

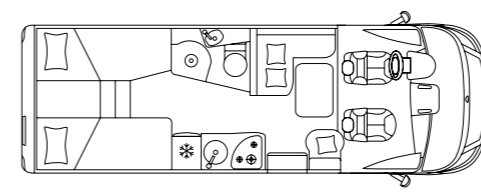

↔ 699 cm 4 (+1)

ECOVIP H3110 MOTORHOME

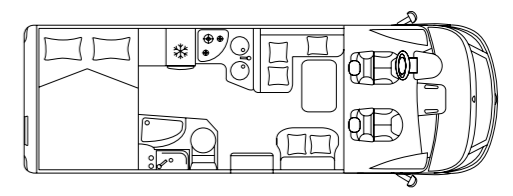

↔ 699 cm 4 (+1)

ECOVIP H3119 MOTORHOME

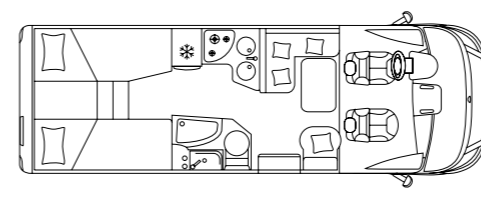

↔ 699 cm 4 (+1)

ECOVIP H3512DS MOTORHOME

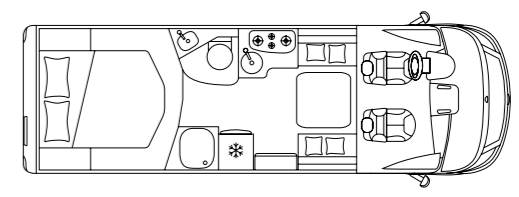

↔ 720 cm 4 (+1)

ECOVIP H4109

MOTORHOME

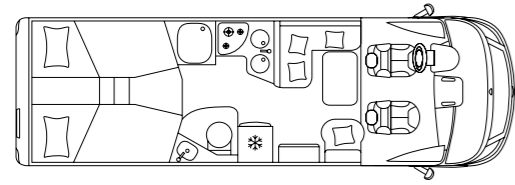

↔ 740 cm  4 (+1)

ECOVIP H4109DS

MOTORHOME

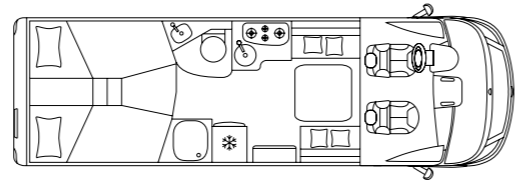

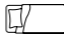
↔ 740 cm  4 (+1)

ECOVIP H4112

MOTORHOME

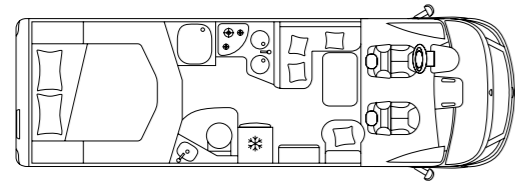

↔ 740 cm  4 (+1)

ECOVIP H4112DS

MOTORHOME

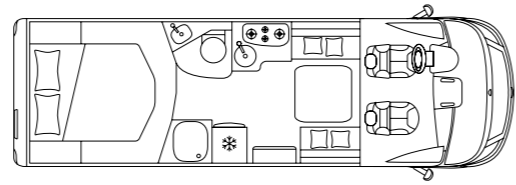

↔ 740 cm  4 (+1)



Scan the QR code and discover more about your favourite model!





The range is rounded off with the Kreos series. Demand for aesthetics, luxury in workmanship and state-of-the-art technology come together to form the ultimate package: an elegant, stylish, versatile motorhome, full of driving comfort and refined design. Italy at it's best.

OUR PREMIUM MODELS

KREOS

A new journey creates a thousand new perspectives. Everything is different, and yet you are surrounded by something you call home. We connect worlds and combine their best properties. The new, the familiar, surrounded by the cornerstones of the Italian lifestyle.

WHAT MAKES KREOS UNIQUE



A real space
miracle.

A deep loading sill stores everything you need for the trip and ensures more stability. This means you have easy access to everything that takes a trip to the highest level.



Comfort as a foundation.

The Kreos' floor is continuous and has no need for steps.



A proper reception.

When the motorhome is unlocked remotely, the exterior and interior lighting turn on and the step automatically extends.



Double finishing.

The spacious double floor with a usable height of up to 37.5 cm is illuminated, heated and accessible from both sides, as well as being covered with GRP.



Everything at a glance.

With the digital on-board and control panel, you always have an overview. The display is user-friendly and easy to use.





The heart of the Kreos is the living area with a room height of 210 cm. An intelligent division not only creates a lot of space optically, but also enough freedom

of movement for everyone accompanying you on your journey. The world is waiting for you.

LIVING ROOM

Natural light sources, indirect lighting.



The folding door between the living and sleeping areas serves as a partition.





The Kreos interior has extremely comfortable pillows and cushions. They'll make you want to sit a little longer.

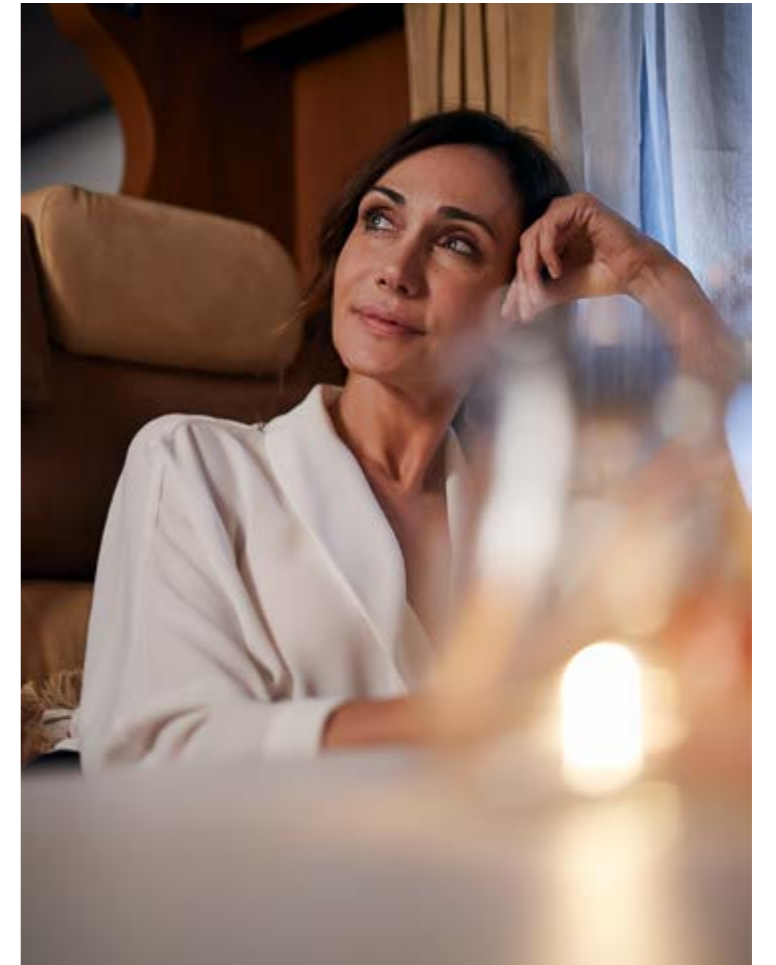



The Kreos series' kitchen shines with its characteristics. Curvy elements, ergonomic shapes and the large work surface made of high-quality 'Corian Soft Touch' are gently highlighted with indirect light. With its many special features, it becomes a place where people like to try something new. With fresh ingredients, sophisticated recipes and a little love, you create a magical atmosphere for long evenings.

KITCHEN

For everything you always wanted to cook.

5010



Crockery and all necessary supplies can be easily stored in the integrated drawers and cupboards.





8012

A bedroom with a view of the starry sky. And this detail is just the beginning. Because the Kreos series creates a great atmosphere with luxury lighting and back-illu-

minated panels in the corners. A spacious, bright room and the stuff dreams are made of.

SLEEPING AREA

Extended luxury.

An ideally used room with sufficient storage space and many freely configurable areas.



8012



Your Italian
spa.



The bathroom is another space for relaxation. A large, separate shower with double drain and white and blue light effects ensures all-round comfort.

BATHROOM



**EXCEPTIONAL
QUALITY MATERIALS.**

Living world Firenze and
furniture décor Noce Italiano



MATERIALS & COMBINATIONS

With the models of the Kreos series, a dark wood look is combined with light elements, creating a balanced colour concept. The design can be individually adjusted and varied in size and shape as required. This way, your home on wheels becomes a fitting continuation of your lifestyle.

LIVING WORLD



Firenze leatherette

FURNITURE DÉCOR

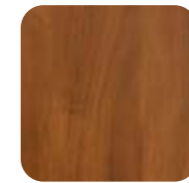

Noce Italiano

OPTIONAL LIVING WORLDS



Alba



Udine leatherette



VIP Club real leather



Noto



The Kreos series also fulfils all wishes in the low-profile version. Well-combined properties and technical highlights make it a model of exceptional class, where comfort and elegance come first.



KREOS 5000 LOW-PROFILES

COMFORT

- Comfortable internal height 210 cm
- Premium XL door with central locking and remote control, two closure points, window, blind, glove box and sliding insect screen
- „Laika Welcome Home System“: electric step extends, external light and entrance lights turn on when unlocking
- Two maxi panoramic roof-lights, one of which is integrated into the driver's cab
- XL 200 cm high shower with internal white/blue LED lighting, double drain, wooden footboard, towel rail and household type 'smoked' door with chrome finishes

DESIGN

- Silver coloured driver's cab (including bumper and handles)
- Exclusive exterior design with automotive LED head- and rear lights, including chrome trim
- Coated aluminium car side skirts including maxi hatches dedicated to external access to the double floor and gas stop pistons

- Large kitchen units with exclusive, high quality mechanical components and indirect interior lighting
- Living room with comfortable upholstery, adjustable headrests, cushions with removable lining and indirect lighting
- Possibility of customisation with drop-down bed above the living room and choice of the rear bed
- LED TV compartment with sliding system, adjustable in height - ideal for use in the living room and for watching the TV from the drop-down bed.
- Toilet with wooden furniture, mirrored wall cabinets, window and roof-lights

TECHNIQUE

- AL-KO chassis with enlarged rear track and reinforced suspensions
- Double floor with total fibreglass covering and complete insulation, heated and luminated with external and internal access to the floor
- Large 160 l trivalent refrigerator with automatic energy source selection
- Gas oven
- Polyurethane wall and roof framework, high insulation in XPS foam, roof lined in hail protection fibreglass, aluminium external walls, anti-yellowing

- Performance-optimised convector heating, Laika exclusive, with radiant elements positioned in all areas of the vehicle to guarantee maximum comfort in all conditions with certification obtained in chamber tests
- Fully antifreeze water system
- Water tanks positioned on heated panels
- Water system easily accessible from the rear garage for every inspection, cleaning and maintenance operation
- Indirect multi-level lighting in the living room, kitchen and bedroom (above wall units, below wall units, along the walls and on the floor), to create a pleasant atmosphere
- Garage with a payload capacity of 250 kg, lowered, heated and insulated loading surface, with two large hatches, floor insulated, 12V, 230V sockets and TV, dual LED lighting, coat hanger rail with sliding rings, fixing bars with rings, two storage nets

The spatial concept of the larger model in the Kreos series appears open and friendly. The room concept is welcoming and spacious. There is enough space here for all your ideas, thoughts and dreams. The Kreos 7000 is based on a Fiat AL-KO chassis.



KREOS 7000 MOTORHOMES

COMFORT

- Driver's door in cab: double closure, safety lock in open position, end-out-line marker lamps and courtesy lighting
- Premium XL door with central locking and remote control, two closure points, window, blind, glove box and sliding insect screen
- „Laika Welcome Home System“: electric step extends, external light and entrance lights turn on when unlocking
- High-tech lighting system, 100 % LED with dimmer function
- Two panoramic roof-lights (95 x 65 cm) in living room and rear bedroom

DESIGN

- One-piece fiberglass front automotive design, large hood for easy and safe access to the engine compartment and aluminium radiator grille
- Exclusive exterior design with automotive LED rear lights with chrome plated trim
- Coated aluminium side skirts including maxi hatches dedicated to external access to the double floor and gas stop pistons
- Insulated/upholstered ceiling with

- elegant Laika-Iso-Deluxe material
- TV rack compartment in living room, with retractable and rollaway 32" TV (TV optional)

TECHNIQUE

- AL-KO chassis with enlarged rear track and reinforced suspensions
- Driver's cab fully thermally and acoustically insulated from the engine compartment and heating even above the dashboard
- Double floor with total fibreglass covering and complete insulation, heated and lightened cavity with external and internal access to the floor
- Large 160 l trivalent refrigerator with automatic energy source selection Performance Cooler Technologie
- Gas oven
- Polyurethane wall and roof framework, high insulation in XPS foam, roof lined in hail protection fibreglass, aluminium external walls, anti-yellowing
- Performance-optimised convector heating, Laika exclusive, with radiant elements positioned in all areas of the vehicle to guarantee maximum comfort in all conditions with certification obtained in chamber tests

- Modern electronic control panel with colour touch screen
- Fully antifreeze water system
- Water tanks positioned on heated panels
- Water system easily accessible from the rear garage for every inspection, cleaning and maintenance operation
- Garage with a payload capacity of 250 kg, lowered, heated and insulated loading surface, with two large hatches, floor insulated, 12V, 230V sockets and TV, dual LED lighting, coat hanger rail with sliding rings, fixing bars with rings, two storage nets

Spacious and technically sophisticated, the Kreos 8000 is in a class of its own. Attention to detail can be found both outside and inside. Built on an Iveco base.



KREOS 8000 MOTORHOMES

COMFORT

- Double car door in driver's cab complete with double glazing, safety lock, open position locking system, clearance and courtesy lights, each equipped with electric step with automatic extraction/reentry (8009 and 8012)
- Premium door (XL for Kreos 8009 and 8012) with two-point remote control, window, blind, storage compartment and sliding mosquito net
- „Laika Welcome Home System“: electric step extends, external light and entrance lights turn on when unlocking
- Dimmable lighting system and separate adjustment of colour temperature (warm light - cold light - except Kreos 8002) via remote control
- Two maxi panoramic roof-lights (95 x 65 cm) in living room and rear bedroom

DESIGN

- One-piece fiberglass front with large hood for easy and safe access and automotive-style aluminum grille
- Modern exterior design with automotive rear and LED headlights with chrome trim
- Coated aluminium side skirts including maxi hatches dedicated to external access to the double floor and gas stop pistons
- Ceiling insulated/covered with fine Laika-Iso-Deluxe material
- TV rack compartment in living room, with retractable and rollaway 32" TV (TV optional)

TECHNIQUE

- Iveco Daily 70 C 18 mechanics, AdBlue, Euro VI, 180 HP (Kreos 8002: Iveco Daily 50 C 16, AdBlue, Euro VI, 160 HP)
- Driver's cab fully thermally and acoustically insulated from the engine compartment and heating even above the dashboard
- Double floor with total fiberglass covering and insulation dedicated to each element, heated and illuminated cavity with external and internal access to the floor

- Large 160 l trivalent refrigerator with automatic energy source selection (AES), High Performance Cooler Technology
- Gas oven
- Polyurethane wall and roof framework, high insulation in XPS foam, roof lined in hail protection fibreglass, aluminium external walls, anti-yellowing
- Exclusive to Laika - Performance-optimised convector heating with radiant elements positioned in all areas of the vehicle to guarantee maximum comfort in all conditions with certification obtained in chamber tests
- Modern electronic control panel with colour touch screen
- Fully antifreeze water system
- External Shower (hot/cold water) in the garage
- Waste water tank with electric drain valve
- Garage with 350 kg payload capacity, lowered, heated and insulated loading surface with two large Easy Lock hatches and locks, insulated subfloor and floor ABS lined washable, double drain for water, 12V, 230V sockets and TV, double Led lighting, coat hanger rail with sliding rings, fixing bars with repositionable rings

KREOS LAYOUTS



Scan the QR code and discover more about your favourite model!

KREOS 5009

LOW-PROFILE

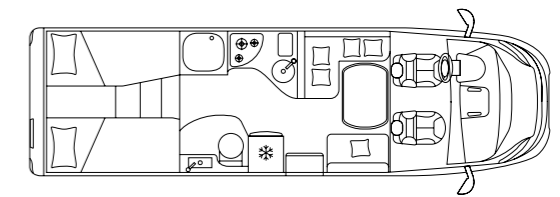

↔ 769 cm

🛏️ 2 (+2 +1)

KREOS 5010

LOW-PROFILE

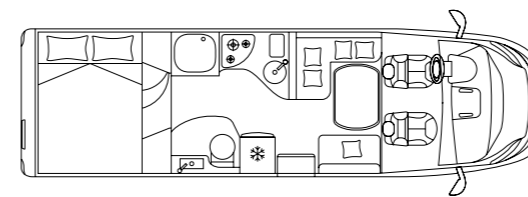

↔ 769 cm

🛏️ 2 (+2 +1)

KREOS 7009

MOTORHOME

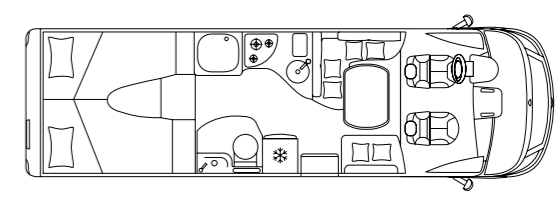

↔ 796 cm

🛏️ 4 (+1)

KREOS 7012

MOTORHOME

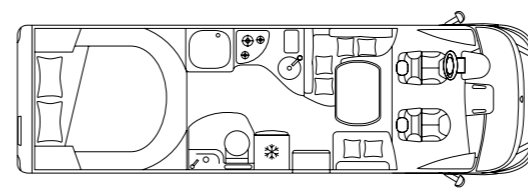

↔ 796 cm

🛏️ 4 (+1)

KREOS 8002

MOTORHOME

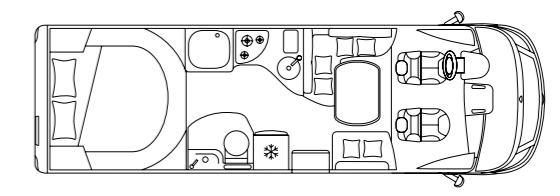

↔ 799 cm

🛏️ 4 (+1)

KREOS 8009

MOTORHOME

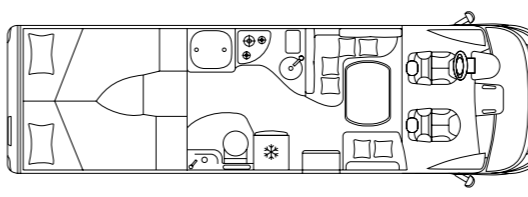

↔ 829 cm

🛏️ 4 (+1)

KREOS 8012

MOTORHOME

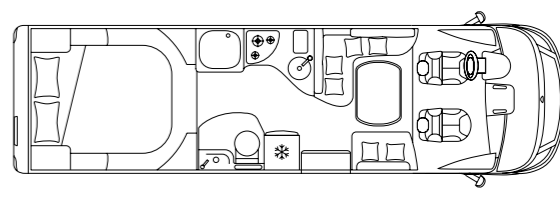

↔ 829 cm

🛏️ 4 (+1)

Tradition

Quality made in San
Casciano since 1964.



&

Craft

The passion for beauty and traditional craftsmanship have always produced works of art of great value in Tuscany. The trade technology used by Laika also comes from a centuries-old tradition of original Tuscan handicraft. The roots of genuine craftsmanship which has been passed down from generation to generation over the centuries are planted in every corner of Tuscany: Wrought iron, ceramics, wool, lace and silk, as well as wood and leather processing are just a few of the treasures this region has to offer. Tuscan carpentry goes back to the 14th century: the production of wine barrels, the carpentry of furniture or the making of violins, all sectors have perfected their craft over the years and decades, making

Tuscany a real centre of excellence for wood processing and furniture production. Florence became the measure of all things in Europe when it came to woodworking, particularly during the Renaissance. Furniture makers who concentrated on the processing of high-quality materials in particular, such as ebony, walnut and olive roots, became true masters in the production of prestige furniture. This unique tradition has been preserved for centuries and has been passed down from one generation to the next. In San Casciano in Val di Pesa, there is still the opportunity to visit traditional, family-run workshops and to experience the original Tuscan art of woodworking up close. Even modern, Tuscan manufacturers rely on the years

of experience and tradition of their ancestors in the production of innovative and functional furniture. A motorhome is a moving home. This makes the composition and assembly of the furniture all the more important. It has to withstand vibrations and driving movements and yet still have a high degree of flexibility in the event of temperature fluctuations or shocks. To meet the demands for stability and flexibility in equal measure, Laika has developed a special furniture assembly system that ensures carefree travel. Laika motorhomes are manufactured with the same care with which a carpenter builds their furniture and with the same passion for detail. This passion and precision distinguish a real Laika from an ordinary motorhome.

Passion and precision distinguish a real Laika from an ordinary motorhome.



Founded in 1964, Laika has produced all motorhomes in San Casciano in Val di Pesa, Italy, without exception, from day one.





It is said that the best travel guides for a new location are the locals themselves. This is especially true in Tuscany, where the warmth and hospitality of the residents reflect the harmony and gentleness of the beautiful

landscapes. Inspired by art and dreams for centuries. Who would be a better guide through this beautiful region than Laika, the Tuscan native.

La Dolce Vita

Discover Italy with Laika

Laika accompanies you through medieval villages and ancient abbeys and discovers the Dolce Vita of Tuscany... and its wines, together with you.

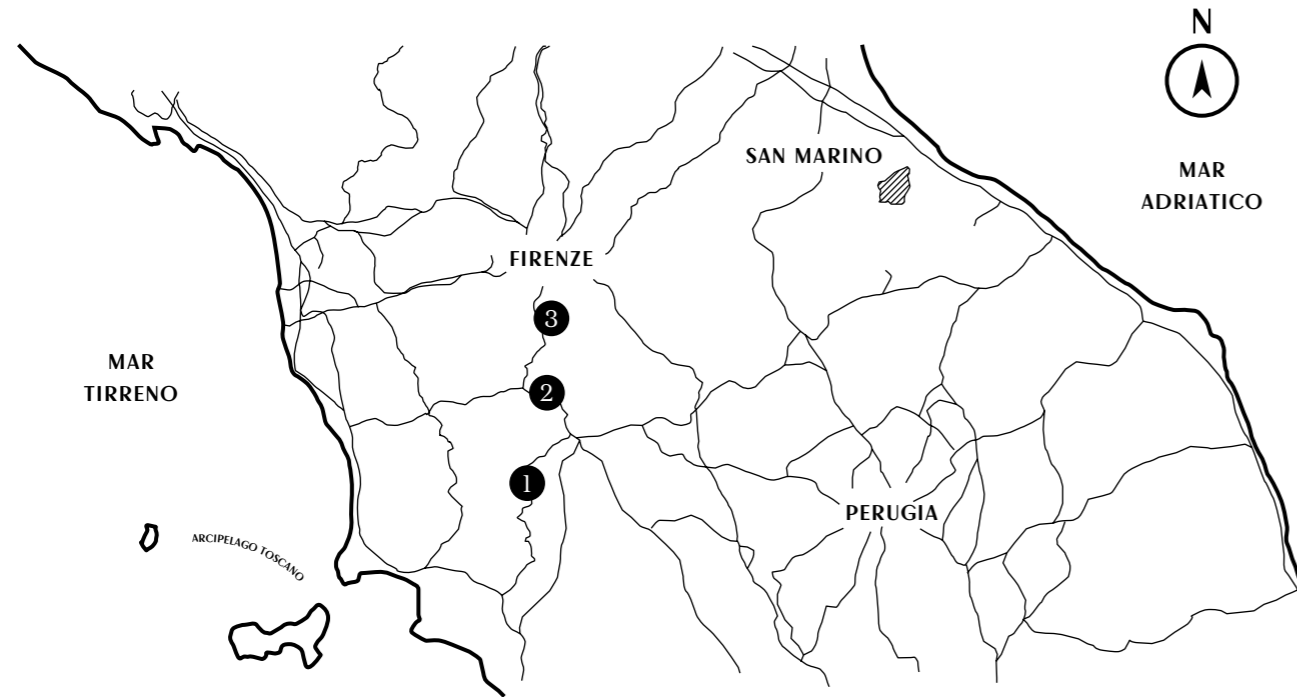

No. 1 San Galgano Abbey Siena

Opening times
Mo - So: 10:00 a.m. - 8:00 p.m.

Address
Strada Comunale di San Galgano
53012 Chiusdino
Siena



Our journey begins at San Galgano Abbey, a Cistercian abbey built in Chiusdino in 1218. Chiusdino is located about 30 km southwest of Siena. The history of San Galgano, after which the church is named, has a lot in common with the stories of medieval knights: after living an ostentatious lifestyle, San Galgano had a sudden enlightenment that led him to withdraw into a hermit life.

The culmination of this change took place on Christmas Day in 1180, when San Galgano rammed his sword into a rock to make a cross out of it. The sword embedded in the rocks is still visible today.

But what makes the Abbey of San Galgano particularly impressive and spectacular is the lack of roof and floor: You can walk on the lawn through the ancient Gothic arches and you just have to look up to see the sky.

This magical place was chosen as the setting for several major films, including 'Nostalgia' by Andrej Tarkovskij and 'The English Patient' by Anthony Minghella. Numerous concerts have also been performed in this picturesque location over the years.

Wines you shouldn't miss:
Brunello di Montalcino,
Montecucco Sangiovese.



No. 2 Monteriggioni Siena

Opening times high season
Mo - So: 9:30 a.m. - 1:30 p.m. / 2:00 - 7:30 p.m.

Tourist Information
P.za Roma, 23
53035 Monteriggioni
Siena



You can reach Monteriggioni, a true jewel of Tuscany, in less than an hour from Chiusdino via the 73b road.

This medieval village on Via Francigena is surrounded by a striking curtain wall and preserves the charm and atmosphere of the past.

The uniqueness of Monteriggioni also inspired Dante, who compared the towers of the village with terrible and menacing giants in his 'Inferno'. In addition to the enormous curtain wall built by the Republic of Siena in the 13th century and stormed by the hostile Florence in the 16th century, Monteriggioni offers numerous medieval buildings, including the "Pieve die Monteriggioni", a church in the Romanesque-Gothic style of the year 1219, which harbours treasures worth seeing, such as a wooden chancel from the 16th century and two tabernacles from the 15th century.

Wines you shouldn't miss:
Vernaccia di San Gimignano,
Chianti Classico



Opening times
 Mo, Tu, We, Fr, Sa: 10:00 a.m. - midday / 3:00 - 5:30 p.m. (Winter 4:30 p.m.)
 So: 3:00 - 5:30 p.m. (Winter 5:00 p.m.)
 Thursday: closed

Address
 Strada di Badia
 50028 Badia a Passignano
 Florence



No. 3 Badia a Passignano Florence



You will reach Badia a Passignano, a fortified monastery embedded in the Chianti hills via the motorway feeder road Florence-Siena to Tavarnelle and then further along the Chiantigiana 94 road.

The abbey was founded by the Benedictine order of Vallombrosa in 1049 and contains numerous historical and artistic testimonies from different eras: the library with scrolls and ancient books, the church of San Michele Arcangelo (13th century) with frescoes by Domenico Cresto, known as Passignano, from 1601, as well as the monastery refectory, where

you can admire a fresco of the Last Supper (15th century) by Domenico and Davide Ghirlandaio. Outside the monastery walls you can stroll through the scenic village, enjoy a good glass of Chianti and admire the wonderful panorama.

Wines you shouldn't miss:
 Chianti Classico, Chianti



Wining & dining



La Grotta dei Tiburzi
 Via Paolo Mascagni 15
 Centro Storico
 53012 Chiusdino
 +39 0577 752948

Osteria Bottega dell'Abate
 Località Abate 6
 53035 Monteriggioni (SI)
 +39 0577 304558

Osteria di Passignano
 Via Passignano 33
 Loc. Badia a Passignano
 50028 Tavarnelle Val di Pesa (FI)
 +39 055 807 1,278

La Cantinetta di Passignano
 Strada di Greve 1 Badia a Passignano
 50028 Tavarnelle Val di Pesa
 +39 055 807 1,975

Parking



Camping Colleverde
 Str. di Scacciapensieri 47
 53100 Siena (SI)
 www.sienacamping.com

Luxor Chianti Village
 Loc. Trasqua - Monteriggioni 53011
 Castellina in Chianti (Siena)
 www.luxorchiantivillage.com



How the dog learned to fly.

There was something in the air. A feeling of the future and change. When Laika was founded, everything seemed possible. And still every journey, large or small, every new destination, is a reach for the stars.

The history of Laika began 56 years ago, in the early years of space exploration when technology, experimentation and future visions were in everyone's minds. The endless ways in which technological innovations can influence everyday life inspired Giovambattista Moscardini to found the Laika brand. The name Laika and the logo, the greyhound, come from the first dog that was shot into space. Future visions, innovations and new travel

ideas: this was exactly what drove Giovambattista Moscardini when producing the first caravan in 1964. Moscardini called his first caravan, innovative and in a futuristic style, 'Laika 500'. The special thing about it: the upper part of the caravan could be lowered while driving due to a telescopic mechanism. This ensured better aerodynamics and greater driving comfort, which meant that the Laika 500 could even be towed by a Fiat 500. This

was followed by many more models, the first factory opening in 1974 and the transition to industrial production. Just a few years later, the first Laika motorhome was born, the 'Motorpolo' series. This was the first motorhome in a long and successful line of Laika vehicles. The longest-lasting Laika range was created in 1992: the iconic Ecovip range. The elegant Kreos series was launched in 1999 and perfectly complemented the product portfolio. As little as a year later, Laika was taken over by the German Erwin Hymer Group. The first wheels were set in motion and some time later, Laika was ready for the next big step: moving to the new plant in San Casciano in Val di Pesa. The Kosmo series was developed in one of the most modern production facilities in the industry and launched on the market in 2018. The Laika brand and its vehicles follow a long tradition of innovation, research, design and an incomparable passion for motorhomes.

The Laika story.



1

- 1 Laika Motorpolo: 1978/79
- 2 Laika Laserhome: Mid/late '80s
- 3 Laika Caravan Yo Yo: End of the '70s
- 4 Laika Laserhome and Laika Lasercar: Mid/late '80s
- 5 Laika Motorpolo: 1978/79
- 6 Laika Laserhome: Mid/late '80s



3



2



4



5



6

GENERAL INFORMATION

Laika Caravans S.p.A. reserves the right, at any time and with no notice, to improve and change the specifications of the cell and frames, furniture and interior design characteristics and the equipment of the vehicles presented in this catalogue. In spite of our careful control, this catalogue may contain misprints. Some of the vehicles shown in the pictures of this catalogue are prototypes not yet serially manufactured at the printing date of this catalogue (August 2020). Some of the vehicles shown in the pictures have accessories not included in the standard equipment, which therefore can be supplied only at an extra price. The pictures may even show pieces of furniture (e.g. plates, glasses...) and other objects, such as TV sets or motorbikes, that are not included in the standard equipment of the vehicles and not marketed by Laika. This catalogue contains the standard equipment and specification characteristics supplied at the print date. The data in the technical data sheets refer to the European type approval, which is valid in all EU Countries. Some data might differ in non-EU Countries due to different applicable regulations. In this case, we recommend contacting the nearest Laika dealer for information concerning local registration laws and the related type-approval data. Your dealer will inform you about any change made to the products after printing the catalogues. All the optionals are available at an extra price. For any particular or special use the Customer should inform the dealer before signing the purchase contract. The images provided are only for illustrative purposes and do not constitute a contractual term.

Art Direction and layout
HammerAlbrecht

Pictures
Korbinian Seifert, Le Officine Fotografiche

Styling
Aleksandra Avellino
Lise Lotte Christiansen

Print
Lito Terrazzi



LAIKA CARAVANS S. P. A.

Via Certaldese 41/A, San Casciano in Val di Pesa , 50026 Florence, Italy
Telephone: +39 055 805 81, Fax: +39 055 805 85 00, email: laika@laika.it
Facebook: LaikaCaravan, Instagram: [laika_Caravans](https://www.instagram.com/laika_Caravans)

LAIKA.IT